

DIN 1891 B

G

Frezy tarczowe trzystone dzielone, ostrza na przemian skośne

Interlocked side and face milling cutters, staggered teeth

Nutenfräser

Фрезы дисковые 3-х сторонние разъёмные с разностаронними зубьями

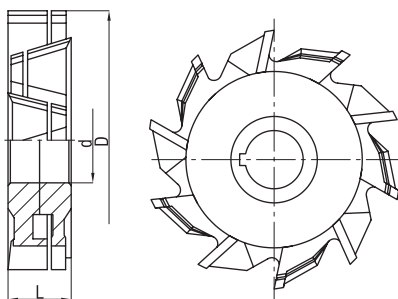

DIN
1891 B

Z=10÷22

$\lambda=11^\circ$
 $\gamma=10^\circ$

ostrza średnie / normal teeth / Mittelschneiden / стандартные зубы

| D (js16) | d (H7) | L (k11) | z | HSS | |
|----------|--------|---------|----|---------|-----------|
| | | | | Code No | 0641-532- |
| 50 | 16 | 10 | 10 | 250105 | ○ |
| 50 | 16 | 12 | 10 | 250207 | ○ |
| 50 | 16 | 14 | 10 | 250309 | ○ |
| 50 | 16 | 16 | 10 | 250400 | ○ |
| 63 | 22 | 12 | 12 | 250502 | ○ |
| 63 | 22 | 14 | 12 | 250604 | ○ |
| 63 | 22 | 16 | 12 | 250706 | ○ |
| 63 | 22 | 18 | 12 | 250808 | ○ |
| 80 | 27 | 12 | 14 | 250849 | ○ |
| 80 | 27 | 14 | 14 | 250864 | ○ |
| 80 | 27 | 16 | 14 | 250900 | ○ |
| 80 | 27 | 18 | 14 | 251004 | ○ |
| 80 | 27 | 20 | 14 | 251106 | ○ |
| 100 | 32 | 12 | 16 | 251147 | ○ |
| 100 | 32 | 14 | 16 | 251208 | ○ |
| 100 | 32 | 16 | 16 | 251249 | ○ |
| 100 | 32 | 18 | 16 | 251300 | ○ |
| 100 | 32 | 20 | 16 | 251401 | ○ |
| 100 | 32 | 22 | 16 | 251503 | ○ |
| 100 | 32 | 25 | 16 | 251544 | ○ |
| 125 | 32 | 16 | 16 | 251605 | ○ |
| 125 | 32 | 18 | 16 | 251646 | ○ |
| 125 | 32 | 20 | 16 | 251707 | ○ |
| 125 | 32 | 22 | 16 | 251809 | ○ |
| 125 | 32 | 25 | 16 | 251900 | ○ |
| 125 | 32 | 28 | 16 | 251941 | ○ |
| 160 | 40 | 20 | 18 | 251967 | ○ |
| 160 | 40 | 22 | 18 | 252005 | ○ |
| 160 | 40 | 25 | 18 | 252107 | ○ |
| 160 | 40 | 28 | 18 | 252209 | ○ |
| 160 | 40 | 32 | 18 | 252300 | ○ |
| 200 | 40 | 20 | 22 | 252402 | ○ |
| 200 | 40 | 22 | 22 | 252504 | ○ |
| 200 | 40 | 25 | 22 | 252606 | ○ |
| 200 | 40 | 28 | 22 | 252708 | ○ |
| 200 | 40 | 32 | 22 | 252800 | ○ |